

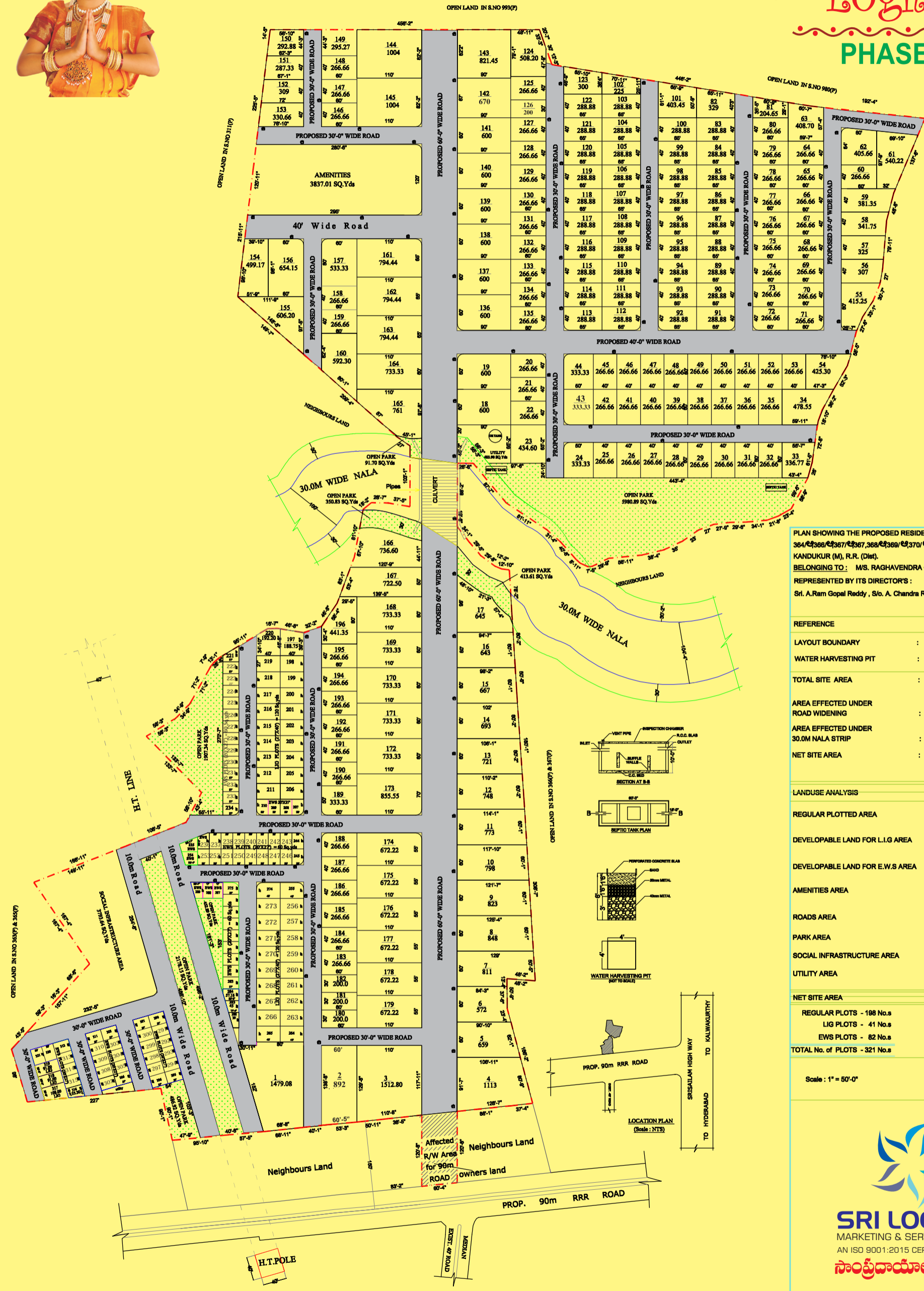

L.P.No.38/LO/HMDA/2015.



Logilla PHASE-I



PLAN SHOWING THE PROPOSED RESIDENTIAL LAYOUT IN SY.NO.S.316, 364/1,366/1,367/1,368/1,369/1,370/1,371/1,373/1, of GUDUR (V), KANDUKUR (M), R.R. (Dist).
 BELONGING TO : M/S. RAGHAVENDRA CONSTRUCTIONS
 REPRESENTED BY ITS DIRECTOR'S :
 Sri. A.Ram Gopal Reddy, S/o. A. Chandra Reddy & Other's

REFERENCE	
LAYOUT BOUNDARY	: - - - - -
WATER HARVESTING PIT	: R.W.H
TOTAL SITE AREA	: 31 Acres 17.79 Gts 152192.89 SQ.Yds.
AREA EFFECTED UNDER ROAD WIDENING	: 807.18 SQ.Yds
AREA EFFECTED UNDER 30.0M NALA STRIP	: 638.17 SQ.Yds
NET SITE AREA	: 31 Acres 5.847 Gts 150747.54 SQ.Yds. 126040.01 SQ.Mts.

LANDUSE ANALYSIS	SQ.Yds	PERCENTAGE
REGULAR PLOTTED AREA	81522.18	54.08%
DEVELOPABLE LAND FOR L.I.G AREA	4832.47	3.20%
DEVELOPABLE LAND FOR E.W.S AREA	4838.28	3.21%
AMENITIES AREA	3837.01	02.55%
ROADS AREA	39508.78	26.21%
PARK AREA	11862.33	07.87%
SOCIAL INFRASTRUCTURE AREA	3793.64	02.52%
UTILITY AREA	552.85	0.36%
NET SITE AREA	150747.54	100.00%

REGULAR PLOTS - 198 No.s
 LIG PLOTS - 41 No.s
 EWS PLOTS - 82 No.s
 TOTAL No. of PLOTS - 321 No.s

Scale : 1" = 50'-0"

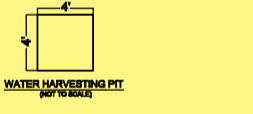
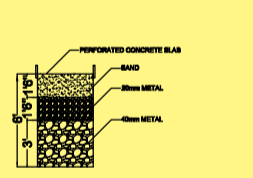
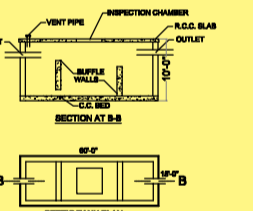

SRI LOGILLU
 MARKETING & SERVICES PVT LTD.
 AN ISO 9001:2015 CERTIFIED COMPANY
 సాంప్రదాయాల పుష్టిని